

# A Better Bath Plan



## **DRY ZONE**

A custom cherry double vanity anchors the wall of one end of the bathroom and provides sufficient floor area in front for comfortable circulation around the two DecoLav vessel sinks.

# Splitting this bath into two zones made it functional and comfortable

BY RICHARD SHUGAR

**T**he Snow Creek Residence in Corvallis, Ore., is a compact three-bedroom house my firm designed to accommodate a young, active family with a limited budget. Located on a steep, secluded slope, the house was designed and detailed to celebrate the style of the Pacific Northwest. The master bathroom expresses an aesthetic similar to the main living spaces in that the owners wanted the small bath to have an open, calm, modern atmosphere.

## Separate, yet connected

The owners had two requests when it came to their master bathroom, one potentially in conflict with the other. They wanted the bathroom to be designed as one large, singular space, but they also wanted it to have a distinct tub/shower area.

To satisfy the first request, we chose to extend large-format tiles around each wall of the bathroom. This gesture creates a visually clean, tranquil space and ultimately unifies the bath. We also clad the entire sloping ceiling in birch plywood, which serves a similar role. To define the tub/shower area, we opted not to build a wall, but instead installed a glass partition. The glass permits long sight-lines throughout the spaces and allows the two distinct areas of the bath to feel like one common space. The result is a calm, simple bathroom that is elegant in detail and efficient in plan. □

Richard Shugar is principal of 2fORM Architecture (2-form.com) in Eugene, Ore. Photos by Lincoln Barbour.



**WET ZONE**

A glass partition keeps water from the Moen fixture (right) contained in the shower area and defines the half of the bath that also includes a tub. The rectangular Jason tub complements large rectangular porcelain tiles installed in a stack bond.



## THE HALVES OF A WHOLE

Separated into a wet zone and a dry zone with a glass partition, the bathroom feels like one united space while compartmentalizing the specific tasks that the space serves.

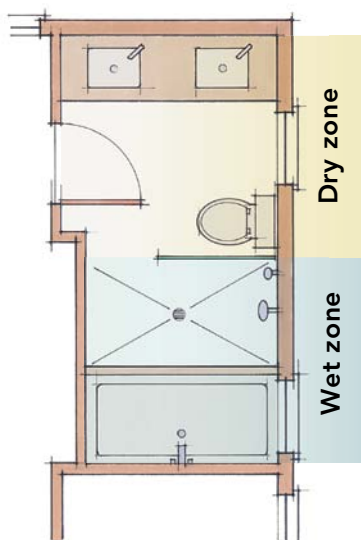

## DETAILS

Countertop: HanStone, Tiffany Grey; hanwhasurfaces.com

Shower faucet: Moen ExactTemp; moen.com

Sink: DecoLav 1423; decolav.com

Tile: Daltile, Fabrique Gris Linen; daltile.com

Architect: Richard Shugar AIA, LEED AP Location: Corvallis, Ore. Builder: Larry E. Coxon, general contractor